

FACT SHEET

South Punyelroo Community Wastewater Management System



Information about the South Punyelroo Community Wastewater Management System

The Community Wastewater Management System (CWMS) at South Punyelroo is called a gravity sewer, which means that no septic tanks or pumps are required on your piece of land. The wastewater gravitates to the main drain, then to the communal pump chamber where it is pumped to the treatment plant where it is simply aerated and chlorinated prior to being discharged at the irrigation site via drippers and sprinklers.

How do I apply to connect to the scheme?

You will need to complete an "Application for an On-site Wastewater Works Approval" form that is available from the Council Offices based at Mannum, Morgan and Cambrai or online at www.mid-murray.sa.gov.au.

What do I need to provide with the application?

With your application form, you will need to provide:

A detailed plumbing layout shown on a House Layout Plan (Figure 1) drawn to a scale of 1 in 100 showing:-

- the position and description of all the sanitary fixtures to be connected to the septic tank e.g. water closet, basin, bath, shower, laundry trough, washing machine, kitchen sink, dishwasher, food waste disposal unit or spa bath (together with its capacity);
- location of the sewer drain, inspection openings, junctions and bends, size and fall of sewer drain, position and size of traps (sanitary fixtures, floor and drain), vents and waste pipes;
- the intended use of the rooms within the building e.g. bedroom, kitchen, family, office, consulting room, dining, bar etc.

A detailed Site Layout Plan drawn to a scale of 1 in 100 showing:-

- block dimensions;
- location of the building and all other structures, sheds, swimming pool, paving and driveways;
- position of the proposed pipeline, including distances from buildings, boundaries etc.

Do I have to pay a fee?

Yes, an application fee is required. Fees can be found on Council's website at www.mid-murray.sa.gov.au or by contacting the Council office.

How long will the approval take?

The approval of your application will take about twenty (20) working days to approve, provided that all necessary information is included. Delays will occur if all information is not submitted.

Can I install the plumbing myself?

People performing or contracted to carry out any plumbing or drainage work must be licensed and/or registered under the Plumbers, Gas Fitters and Electricians Act 1995.

Are any inspections needed?

Council will undertake a site inspection when the connection to the scheme is being undertaken.

The contractor doing the work is required to give prior notice to the Council of at least one business day to book a site inspection of the work with Council's Environmental Health Officer.

It is your obligation to ensure that this notification is given.

Contact

PO Box 28
Mannum SA 5238
T: (08) 8569 0100
E: postbox@mid-murray.sa.gov.au

Principal Office

49 Adelaide Road
Mannum SA 5238

Cambrai Office

Main Street
Cambrai SA 5353

Morgan Office

Cnr Fourth & Eight Streets
Morgan SA 5320

FACT SHEET

South Punyelroo Community Wastewater Management System

What can I do with my existing septic tank?

Your existing septic tank can either be removed or left in the ground. The tank should be desludged if you intend to remove it. If the tank is going to be left in the ground, it should still be desludged, break open the bottom of the tank, place the lid inside and fill with sand (this option may produce odours for an extended period).

Maintenance of the Gravity Sewer

How does the system work?

The sewerage flows (solids and liquids) from the house through a sewer pipe to a communal pump chamber located on common land. Once the sewerage inside the pump chamber reaches a certain level inside the pump turns on and grinds up the sewerage which is then pumped to the treatment plant. The treatment plant then processes the liquid (sewer) which is aerated, treated with chlorine and pumped to an irrigation site located above the floodplain on Murraylands Road.

What should not be put down the drains (toilet, sink or hand basins)

- any stormwater, including roof and rain water tank overflow and surface drainage waters;
- any backflush waters from a swimming pool or water softener;
- any discharge or backflush from a spa bath/pool in excess of 680 litres capacity;
- any sanitary napkins, clothing or plastic material or liner;
- any trade waste;
- any petrol or other flammable or explosive substance whether solid, liquid or gaseous;
- any disinfectant or deodorant, antiseptic or germicide powder or fluid, unless specifically stated to be suitable for use in a septic tank.

Council CWMS Maintenance Officers have attended numerous blockages/pump burn outs in the past to find that people have flushed sanitary products, nappies, clothing and the like down the drains.



This is a photo showing a build up of sanitary products and nappies jamming both valves in the pump ultimately causing the pump to burnout beyond repair. The cost to replace this pump was taken from the maintenance fund for the respective CWMS.

If you have any other questions relating to the South Punyelroo CWMS, please feel free to contact the Council Office on 8569 0100.

Contact

PO Box 28
Mannum SA 5238
T: (08) 8569 0100
E: postbox@mid-murray.sa.gov.au

Principal Office

49 Adelaide Road
Mannum SA 5238

Cambrai Office

Main Street
Cambrai SA 5353

Morgan Office

Cnr Fourth & Eight Streets
Morgan SA 5320

FACT SHEET

South Punyelroo Community Wastewater Management System

Figure 1

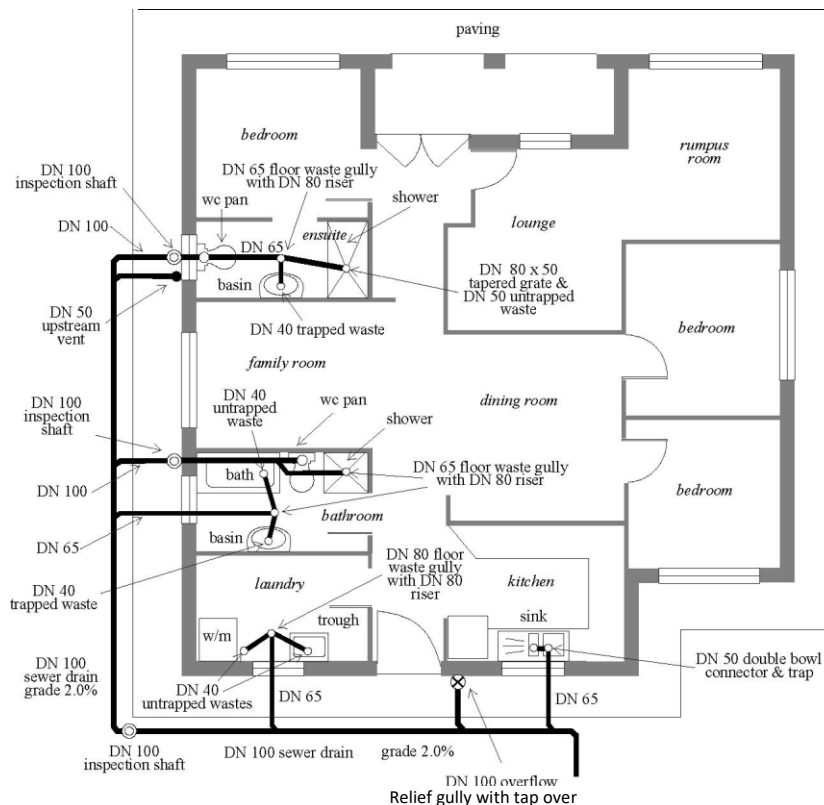

Contact

PO Box 28
Mannum SA 5238
T: (08) 8569 0100
E: postbox@mid-murray.sa.gov.au

Principal Office

49 Adelaide Road
Mannum SA 5238

Cambrai Office

Main Street
Cambrai SA 5353

Morgan Office

Cnr Fourth & Eight Streets
Morgan SA 5320