

FACT SHEET

Rob Loxton Road Community Wastewater Management System



Information about the Rob Loxton Road Community Wastewater Management System

The Community Wastewater Management System (CWMS) at Rob Loxton Road comprises of a series of individual pump chambers that guide and pump sewage to the treatment plant where it is simply aerated and chlorinated prior to being discharged at the irrigation site via droppers and sprinklers.

How do I apply to connect to the scheme?

You will need to complete an "Application for an On-site Wastewater Works Approval" form that is available from the Council Offices based at Mannum, Morgan and Cambrai or online at www.mid-murray.sa.gov.au.

What do I need to provide with the application?

With your application form, you will need to provide:

A detailed plumbing layout shown on a House Layout Plan (Figure 1) drawn to a scale of 1 in 100 showing:-

- the position and description of all the sanitary fixtures to be connected to the septic tank e.g. water closet, basin, bath, shower, laundry trough, washing machine, kitchen sink, dishwasher, food waste disposal unit or spa bath (together with its capacity);
- location of the sewer drain, inspection openings, junctions and bends, size and fall of sewer drain, position and size of traps (sanitary fixtures, floor and drain), vents and waste pipes;
- the intended use of the rooms within the building e.g. bedroom, kitchen, family, office, consulting room, dining, bar etc.

A detailed Site Layout Plan (Figure 2) drawn to a scale of 1 in 100 showing:-

- block dimensions;
- location of the building and all other structures, sheds, swimming pool, paving and driveways;
- position of the proposed pump chamber and pipeline, including distances from buildings, boundaries etc.

What infrastructure am I required to put on my site?

You are required to install a pump chamber with a minimum capacity of 1100 litres. The approved pumps for this CWMS are the Serie Blue Pump GR Blue 200 grinder pump or the Calpeda GMGM6 40A pump. If you wish to use another pump, then you will be required to provide an Engineers report to certify that the pump is equivalent to the Serie Blue or Calpeda pumps and will not compromise the Rob Loxton Road CWMS.

Do I have to pay a fee?

Yes, an application fee is required. Fees can be found on Council's website at www.mid-murray.sa.gov.au or by contacting the Council office.

How long will the approval take?

The approval of your application will take about twenty (20) working days to approve, provided that all necessary information is included. Delays will occur if all information is not submitted.

Can I install the plumbing myself?

People performing or contracted to carry out any plumbing or drainage work must be licensed and/or registered under the Plumbers, Gas Fitters and Electricians Act 1995.

Contact

PO Box 28
Mannum SA 5238
T: (08) 8569 0100
E: postbox@mid-murray.sa.gov.au

Principal Office

49 Adelaide Road
Mannum SA 5238

Cambrai Office

Main Street
Cambrai SA 5353

Morgan Office

Cnr Fourth & Eight Streets
Morgan SA 5320

FACT SHEET

Rob Loxton Road Community Wastewater Management System



Are any inspections needed?

Council will undertake a site inspection at the following stages:

- water testing for underfloor plumbing;
- installation of drain and tanks;
- when the connection to the scheme .

The contractor doing the work is required to give prior notice to the Council of at least one business day to book a site inspection of the work with Council's Environmental Health Officer.

It is your obligation to ensure that this notification is given.

What do I do with my existing septic tank?

Your existing septic tank can either be removed or left in the ground. The tank should be desludged if you intend to remove it. If the tank is going to be left in the ground, it should still be desludged, break open the bottom of the tank, place the lid inside and fill with sand (this option may produce odours for an extended period of time).

Please note: Septic tanks can not be used as pump chambers.

What distance can the pump chamber be from my house or shed?

The minimum distance required is 2.5 metres from the boundary and any buildings on the site. If you believe that you are going to have problems in obtaining this distance, then you will need to contact the Environmental Health Officer to determine the correct positioning of the pump chamber.

Maintenance of Pump Chamber

How does the system work?

The connection to your property is a pit at the boundary containing a valve and 50mm non-return valve (PVC swing type). The sewerage flows into the pump chamber (solids and liquids) from the house and once this reaches a certain level inside the pump chamber the pump turns on and grinds up the sewerage which is then pumped to the treatment plant. The treatment plant then separates the solids from the liquids through a large septic tank and the liquid (effluent) is then aerated, treated with chlorine and pumped to an irrigation site located behind the Walker Flat Transfer Station.

Care of your Pump Chamber

- Regularly lift the lid of your pump chamber and inspect the lid area for tree roots. If tree roots are found around the lid then use a suitable commercially available product and spray around the lid area to prohibit further root growth.
- Don't plant any "water seeking" plants close to your pump chamber as the roots will enter the tank.
- The pump chamber is not designed to handle some chemicals or solids as they can affect the bacteria that break down the solids within the treatment plant. Things such as the following should not be put into your system:-
 - any stormwater, including roof and rain water tank overflow and surface drainage waters;
 - any backflush waters from a swimming pool or water softener;
 - any discharge or backflush from a spa bath/pool in excess of 680 litres capacity;
 - any sanitary napkins, clothing or plastic material or nappies;
 - any trade waste;
 - any petrol or other flammable or explosive substance whether solid, liquid or gaseous;
 - any disinfectant or deodorant, antiseptic or germicide powder or fluid, unless specifically stated to be suitable for use in a septic tank.

Contact

PO Box 28
Mannum SA 5238
T: (08) 8569 0100
E: postbox@mid-murray.sa.gov.au

Principal Office

49 Adelaide Road
Mannum SA 5238

Cambrai Office

Main Street
Cambrai SA 5353

Morgan Office

Cnr Fourth & Eight Streets
Morgan SA 5320

FACT SHEET

Rob Loxton Road Community Wastewater Management System



This is a picture of tree roots that had grown in a pump chamber and actually prevented the pump from working. This caused the effluent to back up into the house.

What to do if...

The pump is continually running – creating a humming sound, then the...

- Valve box or the connection point may have a problem - contact Council.
- Float switch may be faulty. Contact your electrician.
- Pump may be faulty. Contact your electrician.

The alarm light goes on for the pump or if there is no noise and the pump is not working

- Float Switch may be faulty.
- Pump circuit breaker may have tripped off.
- The pump chamber may be full of roots that may be preventing the pump from working – open the lid and check there are no roots. If there are roots, remove them.
- If there are no roots, the pump may be faulty – contact your plumber or electrician.

Please note: If the pump fails, then the original approved pump for this scheme must be installed. If the incorrect pump is installed it either may not work properly or may damage other components of the scheme. You may be held liable for any damages that are incurred to neighbouring properties.

If you have any other questions relating to the Rob Loxton Road CWMS, please feel free to contact the Council Office on 8569 0100.

Contact

PO Box 28
Mannum SA 5238
T: (08) 8569 0100
E: postbox@mid-murray.sa.gov.au

Principal Office

49 Adelaide Road
Mannum SA 5238

Cambrai Office

Main Street
Cambrai SA 5353

Morgan Office

Cnr Fourth & Eight Streets
Morgan SA 5320

FACT SHEET

Rob Loxton Road Community Wastewater Management System

Figure 1

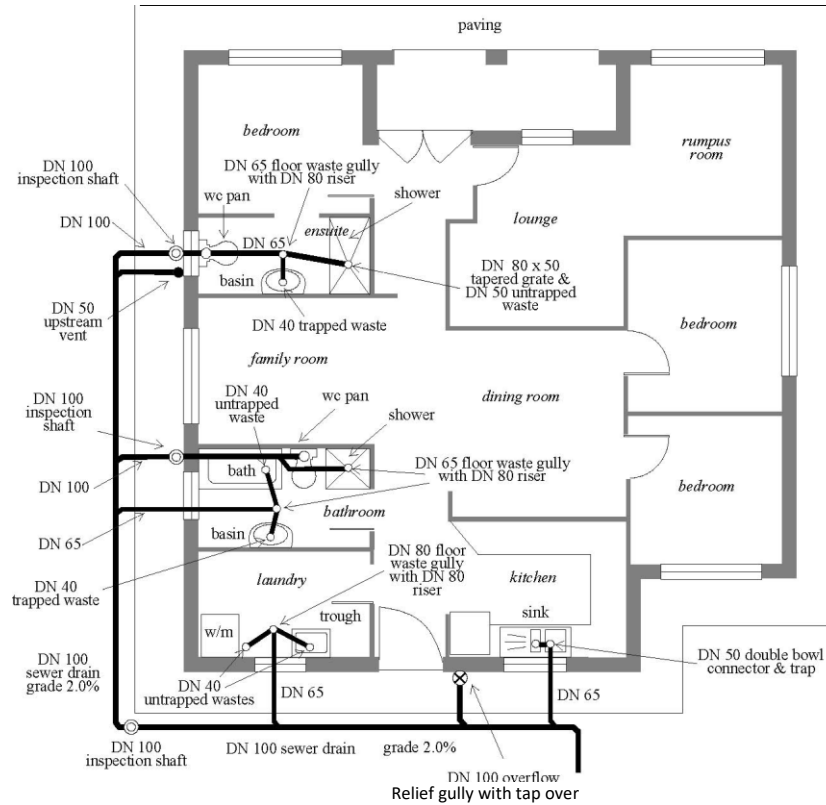
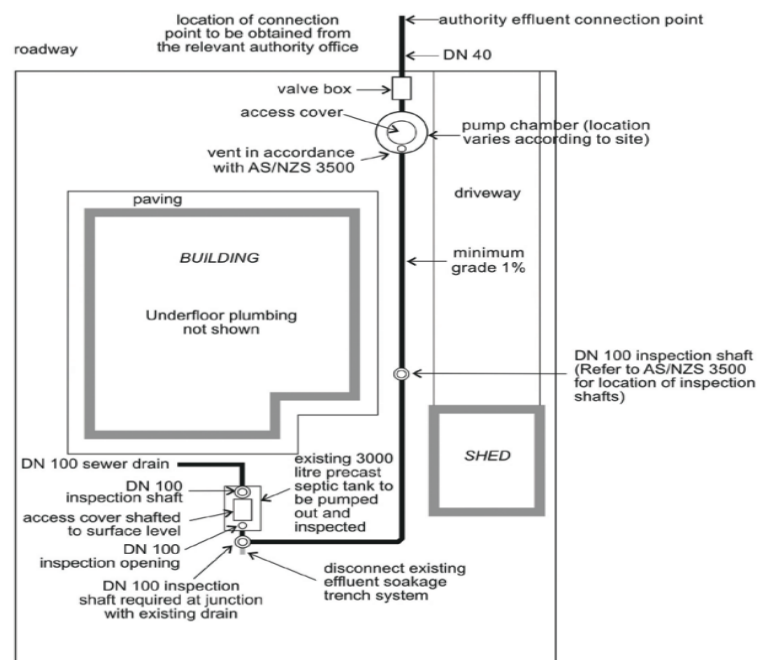

Figure 2



Contact

PO Box 28
Mannum SA 5238
T: (08) 8569 0100
E: postbox@mid-murray.sa.gov.au

Principal Office

49 Adelaide Road
Mannum SA 5238

Cambrai Office

Main Street
Cambrai SA 5353

Morgan Office

Cnr Fourth & Eight Streets
Morgan SA 5320