



## APPLICATION TO CONNECT TO THE TRURO CWMS

This form has been prepared for use in the submission of an application to the Mid Murray Council for approval to connect the sanitary plumbing fixtures and drains for existing and new premises to the Truro Community Wastewater Management System (CWMS).

All sanitary plumbing installations must be installed in accordance with the On-site Wastewater Systems Code issued by the Department for Health and Wellbeing and all applicable Australian Standards.

The information that you are required to submit with this application form are a site plan showing the location of the main sewer drain, any tanks required (septic tank and/or pump sump) and the CWMS boundary connection point. A detailed underfloor plumbing plan of the dwelling is also required. Failure to provide this information will delay the approval process. An application fee of \$243.00 for an existing dwelling or \$371.00 for a new dwelling will also be required.

If you have any questions or queries regarding this application, please contact Development & Environmental Services on (08) 8564 6020.

### **Before you submit this application, have you included:**

- ✓ An application fee of either \$243.00 (existing dwelling) or \$371.00 (new dwelling)
- ✓ A Site Plan
- ✓ An Underfloor Plumbing Plan
- ✓ Your phone number, email and postal address

---

All correspondence to PO Box 28, Mannum SA 5238 ABN 88 313 305 455  
Email [postbox@mid-murray.sa.gov.au](mailto:postbox@mid-murray.sa.gov.au) Web [www.mid-murray.sa.gov.au](http://www.mid-murray.sa.gov.au)

#### **PRINCIPAL OFFICE**

49 Adelaide Road, Mannum, SA  
Telephone: (08) 8569 0100  
Facsimile: (08) 8569 1931

#### **Development & Environmental Services**

Main Street, Cambrai, SA  
Telephone: (08) 8564 6020  
Facsimile: (08) 8569 1931

#### **Morgan & Districts Community Hub**

Cnr Fourth & Eighth Street, Morgan, SA  
Telephone: (08) 8540 0060  
Facsimile: (08) 8569 1931

PLEASE PRINT CLEARLY

## 1. LOCATION OF INSTALLATION

Dwelling number or Lot number \_\_\_\_\_

Street Name \_\_\_\_\_

## 2. OWNER DETAILS

Owner's name \_\_\_\_\_

Owner's address \_\_\_\_\_

Township \_\_\_\_\_ Postcode \_\_\_\_\_ Telephone \_\_\_\_\_

Owner's email address \_\_\_\_\_

Owner's postal address \_\_\_\_\_  
(if different from the above)

Township \_\_\_\_\_ Postcode \_\_\_\_\_ Telephone \_\_\_\_\_

## 3. APPLICANT DETAILS

Where the person completing this application is not the owner, please provide applicant details

Tick as appropriate *Builder*  *Plumber*

Other (please specify) \_\_\_\_\_

Applicant's name \_\_\_\_\_

Applicant's postal address \_\_\_\_\_

Township \_\_\_\_\_ Postcode \_\_\_\_\_ Telephone \_\_\_\_\_

Applicant's email address \_\_\_\_\_

## 4. PLUMBER/ DRAINLAYER DETAILS

Name \_\_\_\_\_

Address \_\_\_\_\_

Township \_\_\_\_\_ Postcode \_\_\_\_\_

Telephone \_\_\_\_\_ Mobile \_\_\_\_\_

Licence number \_\_\_\_\_

Plumber's email address \_\_\_\_\_

*Note: Unless exempted by the Minister under the Plumbers, Gasfitters & Electrician Act, 1995, all 'plumbing' must be carried out by persons authorised in accordance with the provisions of the Plumbers, Gasfitters & Electrician Act, 1995.*

## 5. PREMISES DETAILS

PREMISES DESCRIPTION (*Tick as appropriate*)  Existing  New

Number of People using the system \_\_\_\_\_

## 6. DESCRIPTION OF WORKS

---

---

---

## 7. NON STANDARD FIXTURES TO BE INSTALLED

Food Waste Disposal Unit  Spa Bath (capacity in Litres) \_\_\_\_\_

Other (provide details) \_\_\_\_\_

## 8. SEPTIC TANK

Existing                       New

Size of Septic Tank (capacity in litres) \_\_\_\_\_

Material of construction \_\_\_\_\_

*Please note: If existing, a report from a licensed plumber commenting on the structural integrity and/or the capacity of the existing septic tank may be required.*

## 9. PUMP SUMP AND EFFLUENT PUMP (if applicable)

Existing                       New

Pump Sump Material \_\_\_\_\_

Capacity of Pump Sump (litres) \_\_\_\_\_

Make & Model of Pump \_\_\_\_\_

Type and Location of Alarm \_\_\_\_\_

*Please note: If existing, a report from a licensed plumber commenting on the structural integrity and/or the capacity of the existing pump sump may be required.*

## 10. DECLARATION & SIGNATURE OF OWNER AND APPLICANT

NOTE: Where the applicant is not the owner, then **BOTH** the owner's signature and the applicant's signature are required, otherwise approval will be delayed. The owner should ensure that this form is completed **BEFORE** signing.

I/We hereby declare that the information provided in this application, attachments and accompanying plans is true and correct. I/We hereby declare that I/We will comply with all the conditions of the approval.

Penalties apply for the provision of false or misleading information or failure to install and maintain the system in accordance with approval conditions.

All work on the waste control system, must be carried out by persons licensed pursuant to the Plumbers, Gasfitters and Electricians Act, 1995.

Owner's signature \_\_\_\_\_ Date \_\_\_\_\_

Applicant's signature \_\_\_\_\_ Date \_\_\_\_\_

NOTE: All applications must be accompanied with the appropriate fee. Please contact the relevant authority for details.



## **INFORMATION ON CONNECTING TO THE TRURO CWMS**

### **Information about the Truro CWMS**

The scheme at Truro is called a Community Wastewater Management System (CWMS), which means that you must have a septic tank to gravitate the effluent to the treatment plant. There are a few properties that require a pump chamber also. The wastewater is pumped to the treatment plant in the neighbouring Council area for treatment and disposal. Please note this system is an effluent only system and a septic tank must be used.

### **How do I apply to connect to the scheme?**

You will need to complete an "Application to connect to Truro CWMS" form that is available from the Council Offices based at Mannum, Morgan and Cambrai or online at [www.mid-murray.sa.gov.au](http://www.mid-murray.sa.gov.au).

### **What do I need to provide with the application?**

With your application form, you will need to provide:

A detailed Site Layout Plan drawn to a scale of 1 in 100 showing:-

- block dimensions;
- location of the building and all other structures, sheds, swimming pool, paving and driveways;
- position of the proposed septic tank and pump sump and proposed pipeline, including distances from buildings, boundaries etc.

### **Existing Plumbing Installation**

Council may allow connection of existing plumbing installation to the CWMS, even if the installation does not comply with the current plumbing standards, subject to the following conditions:-

- a copy of the original approval and layout plan must be attached to the application for connection to a CWMS;
- certification by a licensed plumber that the existing installation is of a sound standard and is unlikely to cause offensive conditions must be attached to the application for connection to a CWMS;
- where the existing plumbing and drainage is inadequate and poses a risk to health, or causes offensive conditions, Council under the provisions of the Waste Water Regulations and as a condition of approval, will require upgrading of the existing plumbing and drainage to ensure a satisfactory standard and prevent or remove unsanitary conditions. For example, drain vents, an overflow relief gully and fixture traps will be required to prevent the flow of CWMS drain gas or backflow of raw sewage or sullage into the premises. Inspection openings and or inspection shafts may also be required to ensure access to the drains for maintenance of the system.

### **Do I have to pay a fee?**

An application fee of \$243.00 for existing dwellings or \$371.00 for new dwellings (discounted from \$499.00) is required.

### **How long will the approval take?**

The approval of your application will take about twenty (20) working days to approve, provided that all necessary information is included. Delays will occur if all information is not submitted.

### **Can I install the plumbing myself?**

People performing or contracted to carry out any plumbing or drainage work are required to be licensed and/or registered under the Plumbers, Gas Fitters and Electricians Act 1995.

### **Are any inspections needed?**

Council will undertake a site inspection when the connection to the scheme is being undertaken.

The contractor doing the work is required to give prior notice to the Council of at least one business day to book a site inspection of the work with Council's Environmental Health Officer.

It is your obligation to ensure that this notification is given.

### **Can I use my existing septic tank?**

Your existing septic tank can be used provided that it is in good condition and is of an approved capacity. You must obtain a letter from your liquid waste removalist or a plumber to state that the existing septic tank is in good condition and also the approximate size of the tank.

### **Maintenance of Septic Tank**

To ensure your septic system is working properly it is important to look after your system. Septic tanks should:

- Be desludged every 4 years. Council will coordinate this service as part of your maintenance fee.
- Regularly be checked for any debris, grass or tree roots from around the lid area and removed.
- Strong bleaches or detergents should not be placed down the septic system.

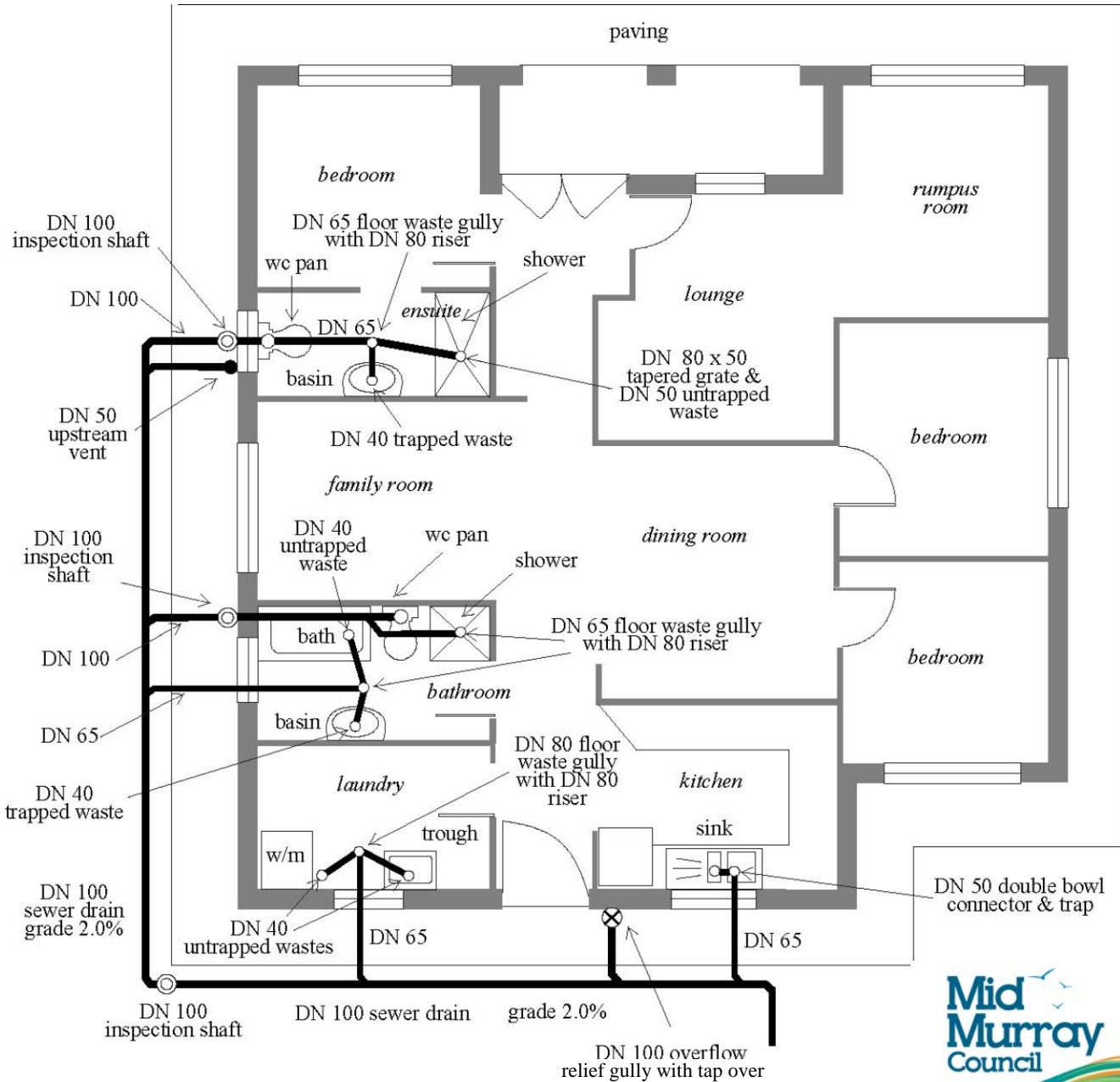

To be drawn to a scale of 1:100

**FIGURE 1: BUILDING LAYOUT PLAN**

(Schematic & reduced for printing)

**Mid Murray Council**  
**Phone: 8564 6020**  
**Fax: 8569 1931**  
**Main Street, Cambrai**  
**49 Adelaide Road, Mannum**  
**Fourth Street, Morgan**  
 Email: [postbox@mid-murray.sa.gov.au](mailto:postbox@mid-murray.sa.gov.au)  
 Web: [www.mid-murray.sa.gov.au](http://www.mid-murray.sa.gov.au)  
 PO Box 28, Mannum SA 5238